



TUNING FORK UNIT

SF-1610 New Product

Applications

• Consumer Mobile Equipment

Features

• Small / Low Profile (1.6×1.0×0.5) • Ceramic Package • Pb Free , Reflow Compatible

Specifications



Model	SF-1610
Nominal frequency range	%(*]: I
Storage temperature range	-40°C~+85°C
Operating temperature range	-40°C~+85°C
Frequency tolerance (at +25°C)	±20 X 10 ⁻⁶
Load capacitance	(b8) b8 +B8 # \$z b8
Equivalent series resistance	90 kΩ Max.
Shunt capacitance	1.2 pF Typ.
Motional capacitance	6.0 fF Typ.
Turnover Temperature	+25°C ± 5°C
Parabolic Coefficient	-0.04ppm / °C ² Max.
Level of drive	0.1 μW (0.5 μW Max.)
Aging	±3ppm / Year

Package quantity: 3,000pcs max./Reel.

Outline and Dimensions [unit:mm]

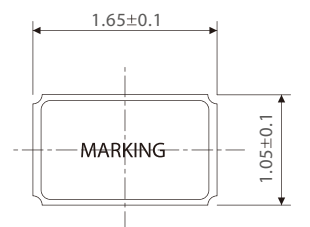

TOP VIEW

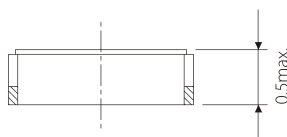
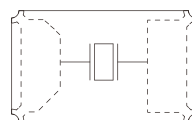

Example of a Terminal Land Pattern

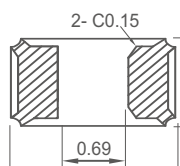
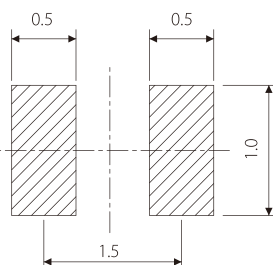

Maximum marking length	Marking
line1	Laser
5	Laser
ex.)	SF925