

OCXO / oven Controlled Crystal Oscillator

6X Series Thru-hole 20×20 OCXO

5MHz~40MHz

O: CMOS

Size:20.6×20.6×11.0 mm

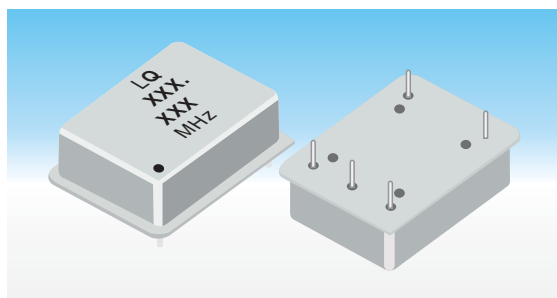

Features

- Dimension 36.3×27.2×12.7mm, 5 pin dip full metal package
- 3.3V /5.0V /12V supply voltage
- Voltage control (Electronic Frequency Tuning) is standard
- Output wave: True sine wave /Square wave
- High frequency range: 5MHz~100MHz
- SC-Cut crystal
- Application for telecom system, Test & Instrumentation, Instrument reference, Data communications, GPS, etc
- RoHS Compliant /Pb Free



Standard Specifications

Item		6X Series Thru-hole 36×27 OCXO	
Output Frequency Range		5MHz~100MHz	5MHz~40MHz
Supply Voltage		3.3V /5.0V /12V	
Output Level		True Sine Wave 7dBm~11dBm Harmonics: -30dBc max. Spurious: -100dBc max.	Square Wave "0" level 0.1×Vcc V max., "1" level 0.9×Vcc V min. Symmetry: 45~55%
Output Load		50Ω	15pF
Power Consumption		1.9 Watts max. at steady-state; 850mA max. at turn-on.	
Frequency Stability	vs. Initial Calibration Tolerance	±100ppb max.	
	vs. Temperature	±3ppb~±100ppb max.	
	vs. Supply Voltage	±0.5ppb max. (Vcc±5%)	
	vs. Warm-up Time	10 minute max. Within ±10ppb of its reference frequency.	
	vs. Aging	±0.5ppb max./after 30 days; ±50ppb max./first year; ±300ppb max. over 10 years.	
Rise and Fall Time		7nS (max.) (20%~80% of waveform)	
Voltage Control On Pin1 (EFC) (Electrical Freq. Tuning)	Frequency Adjustment Range	±0.5~±2ppm	
	Control Voltage Range	+1.65V±1.65V@3.3V, +2.5V±2.5V@5.0V, +4V±4V@12V	
	Transfer Function	Positive: Increasing control voltage increases output frequency	
	Input Impedance	50KΩ min.	
	EFC Linearity	±10% max.	
Phase Noise @10MHz	Offset 10Hz	-120dBc/Hz	
	Offset 100Hz	-135dBc/Hz	
	Offset 1KHz	-145dBc/Hz	
	Offset 10KHz	-150dBc/Hz	
Operating Temperature Range		-30~+85°C, -40~+85°C, or specify	
Storage Temperature Range		-55~+125°C	

Dimensions

[mm]

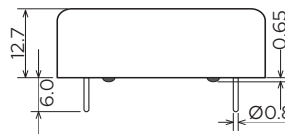
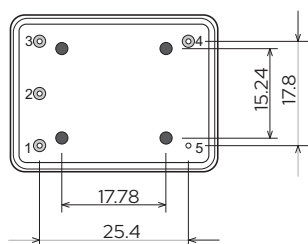
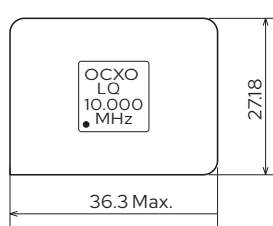

Pin Connections	
Pin No.	Connection
#1	Vcont:EFC GND/NC
#2	NC
#3	Vcc
#4	Output
#5	GND